

**BARBECUES : RBS CLASSIC - RBS  
WOODY & RBS WOODY DELUXE**



**RBS CLASSIC**



**RBS WOODY**



**RBS WOODY DELUXE**

**BARBECUES : RBS CLASSIC - RBS WOODY & RBS WOODY DELUXE**

**SIDE STOVE / RECHAUD LATERAL**

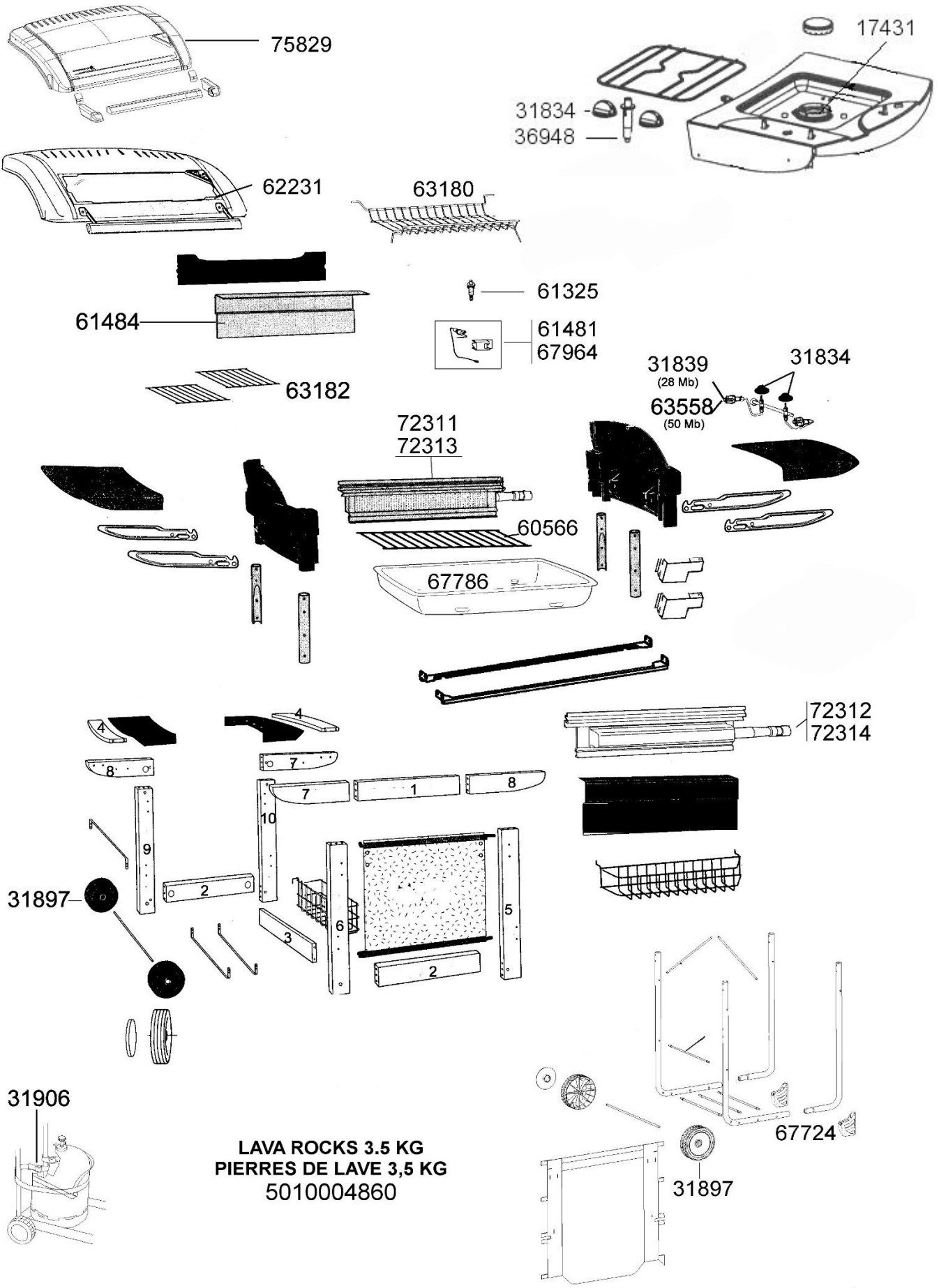

# BARBECUES : RBS CLASSIC - RBS WOODY & RBS WOODY DELUXE



| SPARE PARTS REF. | POINTS | EN DESCRIPTIONS                            | FR DESCRIPTIONS                           | CLASSIC | WOODY | WOODY DELUXE |
|------------------|--------|--|---|---------|-------|--------------|
| 17431            | 60     | CRIMPED BURNER + CAP                       | BRULEUR SERTI + CHAPEAU                   |         |       | X            |
| 31834            | 30     | FRONT PANEL KNOB (x2)                      | VOLANT DE CONSOLE (x2)                    | X       | X     | X            |
| 31839            | 30     | JET  | INJECTEUR                                 | X       | X     | X            |
| 31897            | 50     | WHEEL DIAMETER 175 (X 1)                   | ROUE DIAMETRE 175 (X 1)                   | X       | X     | X            |
| 31906            | 30     | CYLINDER STRAP                             | SANGLE BOUTEILLE                          | X       | X     | X            |
| 36948            | 60     | SIMPLE IGNITER                             | PIEZO SIMPLE                              |         |       | X            |
| 60566            | 90     | LAVA ROCK GRATE                            | GRILLE PIERRE DE LAVE                     | X       | X     | X            |
| 61325            | 60     | DOUBLE IGNITOR                             | PIEZO DOUBLE                              | X       | X     | X            |
| 61481            | 50     | ELECTRODE ROUND SOCKET + SUPPORT           | ELECTRODE COSSE RONDE + SUPPORT           | X       | X     | X            |
| 61484            | 110    | FRONT OR REAR PANEL                        | TOLE AVANT OU ARRIERE                     | X       | X     | X            |
| 62231            | 60     | GLASS SQUARE SUPPORT (x4)                  | EQUERRE VITRE (x4)                        | X       | X     | X            |
| 63180            | 110    | ARTICULATED WARMING GRATE                  | GRILLE DE MIJOTAGE ARTICULEE              | X       | X     | X            |
| 63182            | 110    | ENAMELLED 1/2 COOKING GRID                 | 1/2 GRILLE CUISSON EMAILLEE               | X       | X     | X            |
| 63558            | 30     | JET  | INJECTEUR                                 | X       | X     | X            |
| 67724            | 40     | FOOT                                       | PIED                                      | X       |       |              |
| 67786            | 130    | BASE BOTTOM                                | FOND DE CUVE                              | X       | X     | X            |
| 67964            | 50     | ELECTRODE FLAT SOCKET LONG WIRE AND HOLDER | ELECTRODE FIL LONG COSSE PLATE ET SUPPORT | X       | X     | X            |
| 72311            | 400    | REAR BURNER 28Mb WITH INTEGRATED RAIL      | BRULEUR ARRIERE 28Mb AVEC RAIL INTEGRE    | X       | X     | X            |
| 72312            | 400    | FRONT BURNER 28Mb WITH INTEGRATED RAIL     | BRULEUR AVANT 28Mb AVEC RAIL INTEGRE      | X       | X     | X            |
| 72313            | 400    | REAR BURNER 50Mb WITH INTEGRATED RAIL      | BRULEUR ARRIERE 50Mb AVEC RAIL INTEGRE    | X       | X     | X            |
| 72314            | 400    | FRONT BURNER 50Mb WITH INTEGRATED RAIL     | BRULEUR AVANT 50Mb AVEC RAIL INTEGRE      | X       | X     | X            |
| 75829            | 450    | LID MOD. 2008                              | COUVERCLE MOD. 2008                       | X       | X     | X            |
| 5010004860       | 50     | LAVA ROCKS 3.5 KG                          | PIERRES DE LAVE 3,5 KG                    | X       | X     | X            |