

**MULTI-FUEL BACKPACK STOVE (550)
RECHAUD SAC A DOS MULTI-
CARBURANT**

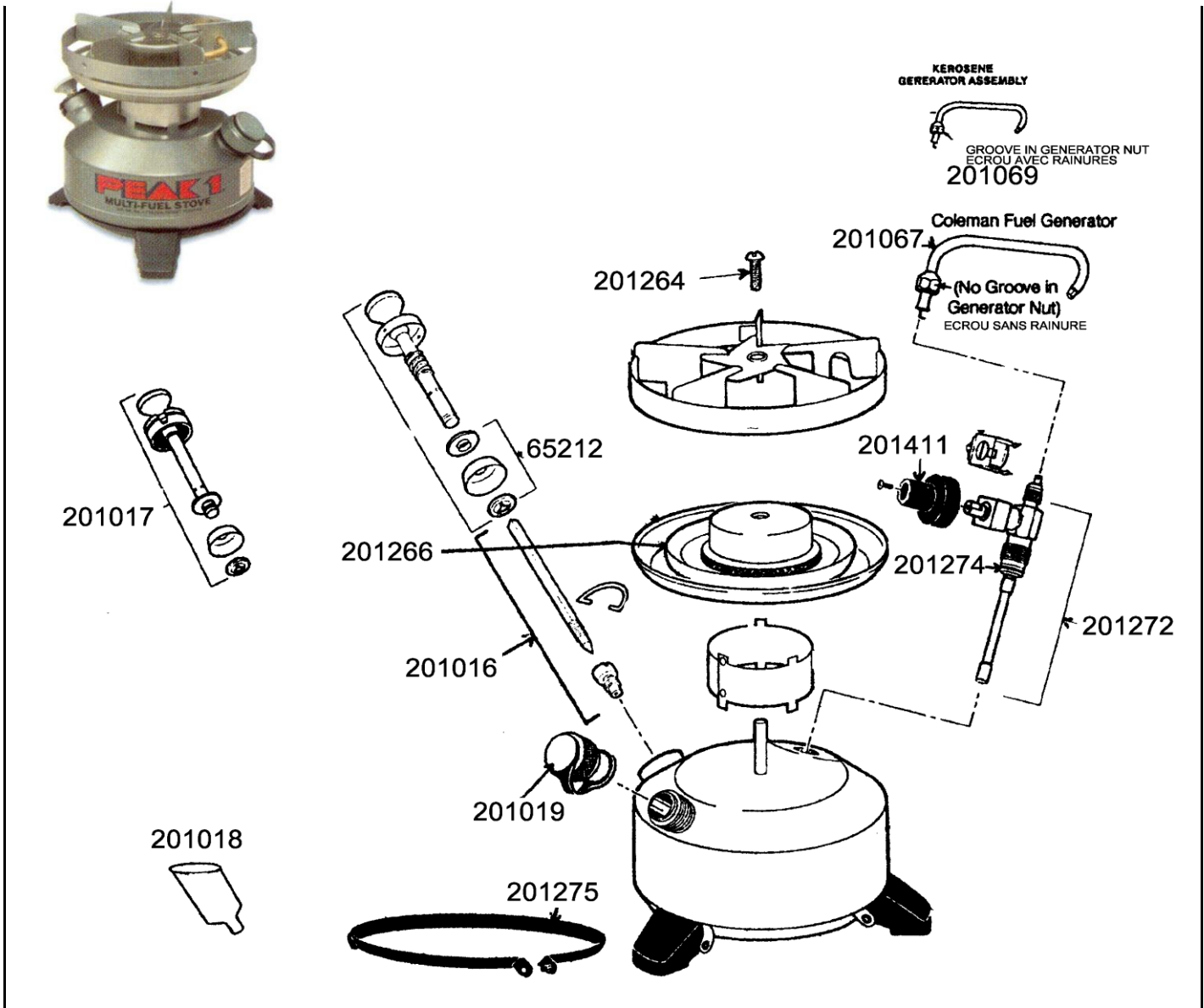

| REF. | POINTS | GB DESIGNATIONS | DESIGNATIONS F |
|--------|--------|-------------------------------|-------------------------------|
| 65212 | 80 | PUMP CUP & CLIP (BLISTER PKG) | JOINT PISTON POMPE (BLISTER) |
| 201016 | 50 | AIR STEM & CHECK VALVE | ENSEMBLE CLAPET DE RETENUE |
| 201017 | 70 | PUMP PLUNGER CURRENT MODEL | PLONGEUR DE POMPE MOD. ACTUEL |
| 201018 | 60 | FILTER FUNNEL | ENTONNOIR |
| 201019 | 70 | FILLER CAP | BOUCHON DE REMPLISSAGE |
| 201067 | 130 | UNLEADED GENERATOR | GENERATEUR ESSENCE |
| 201069 | 130 | KEROSENE GENERATOR | GENERATEUR KEROSENE |
| 201264 | 50 | SCREW | VIS |
| 201266 | 150 | BURNER BOWL ASSEMBLY | ENSEMBLE BRULEUR |
| 201272 | 200 | VALVE ASSEMBLY | ROBINET |
| 201274 | 40 | 'O' RING (X2) | JOINT TORIQUE (X2) |
| 201275 | 50 | LEVELLING RING | ANNEAU DE MISE A NIVEAU |
| 201411 | 50 | KNOB AND SCREW | VOLANT+VIS |