

**THERMO-ELECTRIC COOLERS :
GLACIERES THERMO-ELECTRIQUES:
POWERBOX 24 L/28 L CLASSIC-AP &
COMFORT**

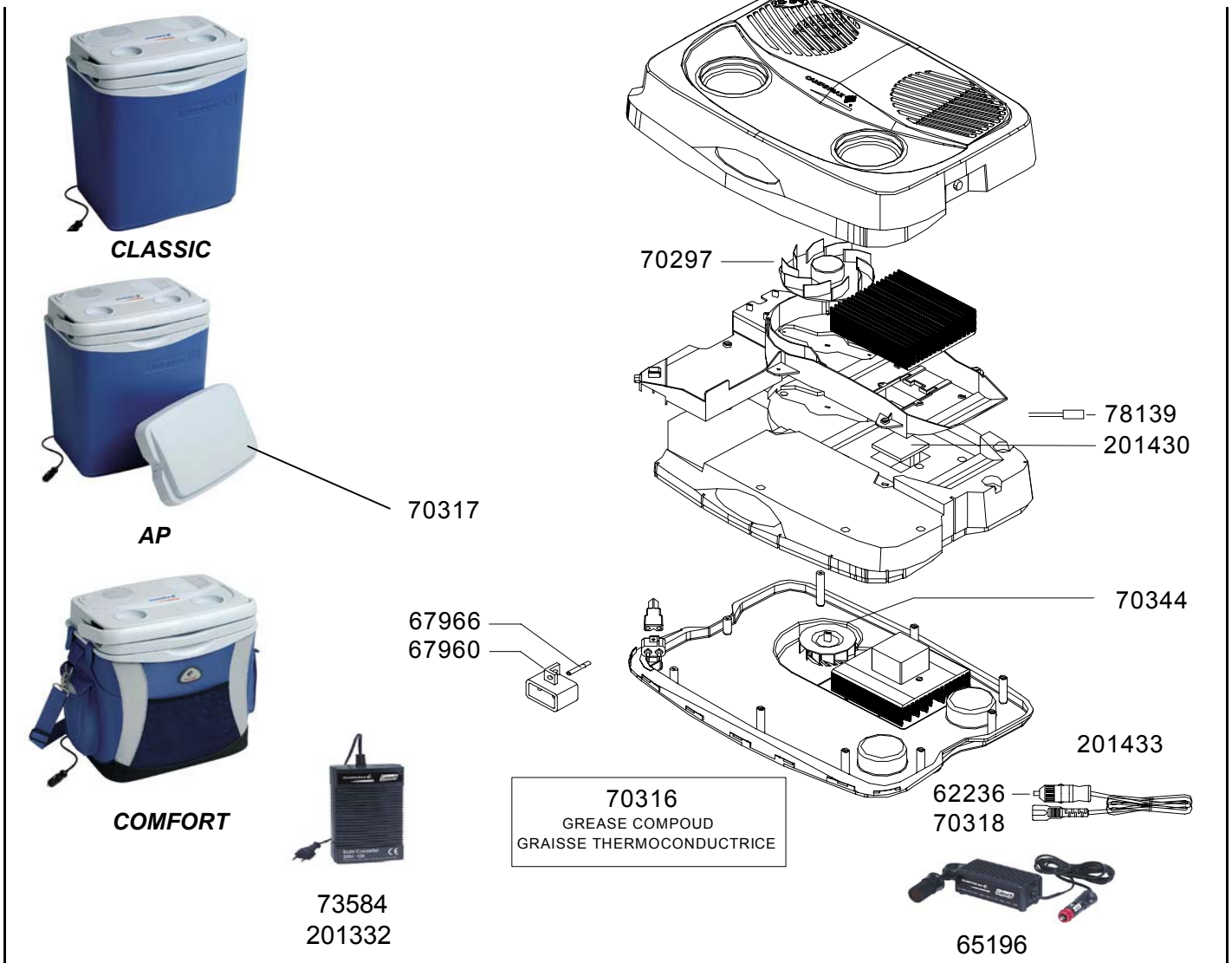

REF.	POINTS	GB DESIGNATIONS	DESIGNATIONS F	CLASSIC - COMFORT	CLASSIC AP
62236	30	FUSE (X2) 7A/250V (6x30)	FUSIBLE (X2) 7A/250V (6x30)	X	X
65196	320	CONVERTER 24V/12V	CONVERTISSEUR 24V/12V	X	X
67960	30	MALE PLUG	FICHE MALE	X	X
67966	30	DIODE	DIODE	X	X
70297	100	MOTOR	MOTEUR	X	X
70316	70	THERMAL JOINT COMPOUND	GRAISSE THERMO-CONDUCTRICE	X	X
70317	100	PASSIVE LID - WHITE	COUVERCLE PASSIF - BLANC		X
70318	30	FUSE (x 2) 7A/250V (5x20)	FUSIBLE(x 2) 7A/250V (5x20)	X	X
70344	30	SMALL PROPELLER	PETITE HELICE	X	X
73584	30	FUSE 1,6 AMP	FUSIBLE 1,6 AMPERE	X	X
78139	60	THERMAL FUSE	THERMOFUSIBLE	X	X
201332	240	ACCESSORY CONVERTER 230V/12V	ACCESSOIRE TRANSFORMATEUR 230V/12V	X	X
201430	300	THERMO ELECTRIC ELEMENTS	ELEMENTS THERMO-ELECTRIQUES	X	X
201433	120	POWER CORD	CORDON	X	X