

# SOUDOGAZ T 206

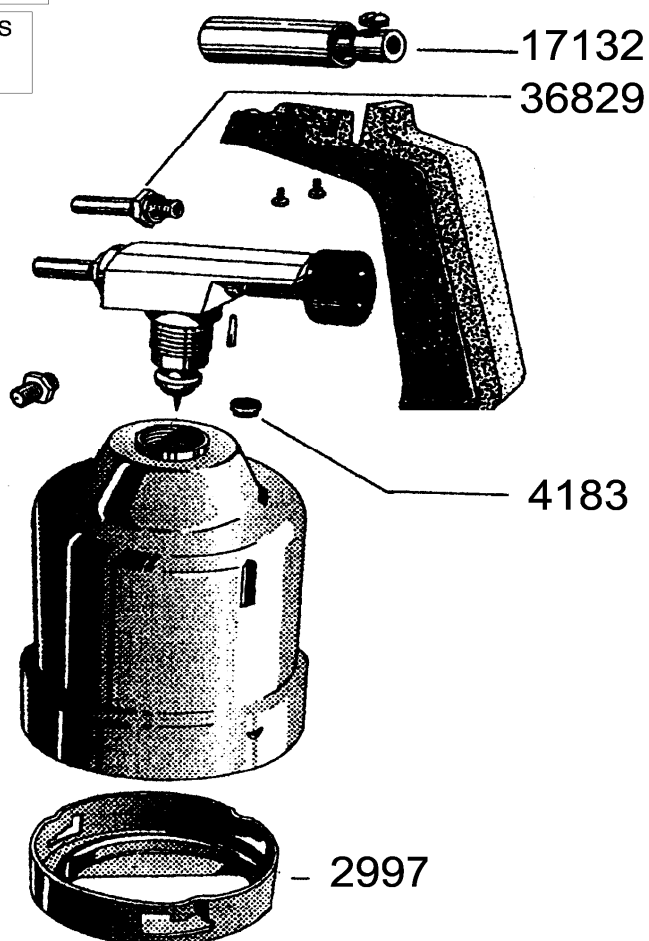

IN ORDER TO USE THESE TWO TIPS, IT IS NECESSARY TO ORDER THE ADAPTATOR 37289

POUR POUVOIR MONTER CES DEUX BUSES, COMMANDER L'ADAPTATEUR 37289

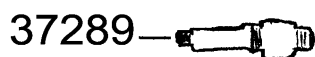
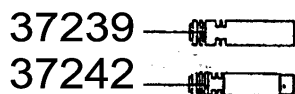

REF.	POINTS	GB - DESIGNATIONS	DESIGNATIONS - F
2997	70	BAYONET BASE	SOCLE
4183	90	PISTON WASHER (X20)	JOINT ANTI FUITE PISTON (X20)
17132	83	BURNER	BUSE MONTEE
36829	90	ADAPTATOR XT SOUDO T 206	ADAPTATEUR XT SOUDO T 206
37239	91	FLAME BURNER X1700	POINTE FINE X1700
37242	100	FINE FLAME BURNER X 1650	POINTE X 1650
37289	50	ADAPTOR	ADAPTATEUR