

GARDEN TORCH CV470 PZ & MULTIPURPOSE CV GARDEN TORCH

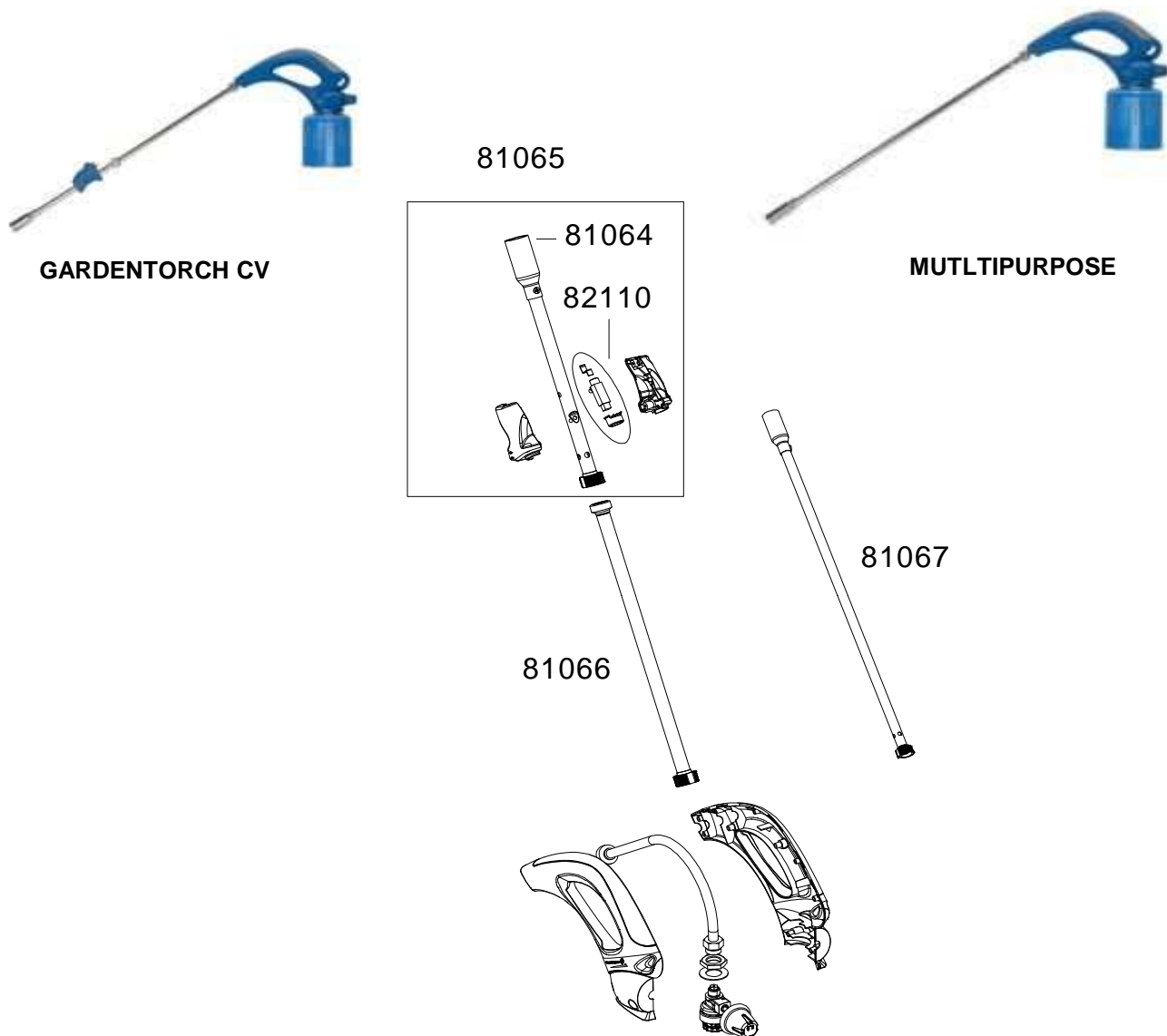

| REF . | POINTS | GB DESIGNATIONS | DESIGNATIONS F | GARDEN TORCH | MULTIPURPOSE |
|-------|--------|-------------------------------------|--------------------------------|--------------|-----------------|
| | | | | CV470 PZ | GARDEN TORCH CV |
| 81064 | 50 | BURNER END | BUSE | X | X |
| 81065 | 100 | BURNER WITH PIEZO IGNITOR | LANCE AVEC PIEZO | X | |
| 81066 | 80 | BURNER TUBE UPPER PART | LANCE PARTIE HAUTE | X | |
| 81067 | 100 | BURNER TUBE | LANCE MONOBLOC | | X |
| 82110 | 60 | PIEZO + BUTTON + CONNECTOR STRIP PZ | PIEZO + BOUTON + CONNECTEUR PZ | X | |