

BARBECUES PRIMERO - PRIMERO CLASSIC & CLASSIC DUO



PRIMERO



PRIMERO CLASSIC



PRIMERO CLASSIC DUO

Jets / Injecteurs :
 28 mb : 63558 - 75802
 50 mb : 66340

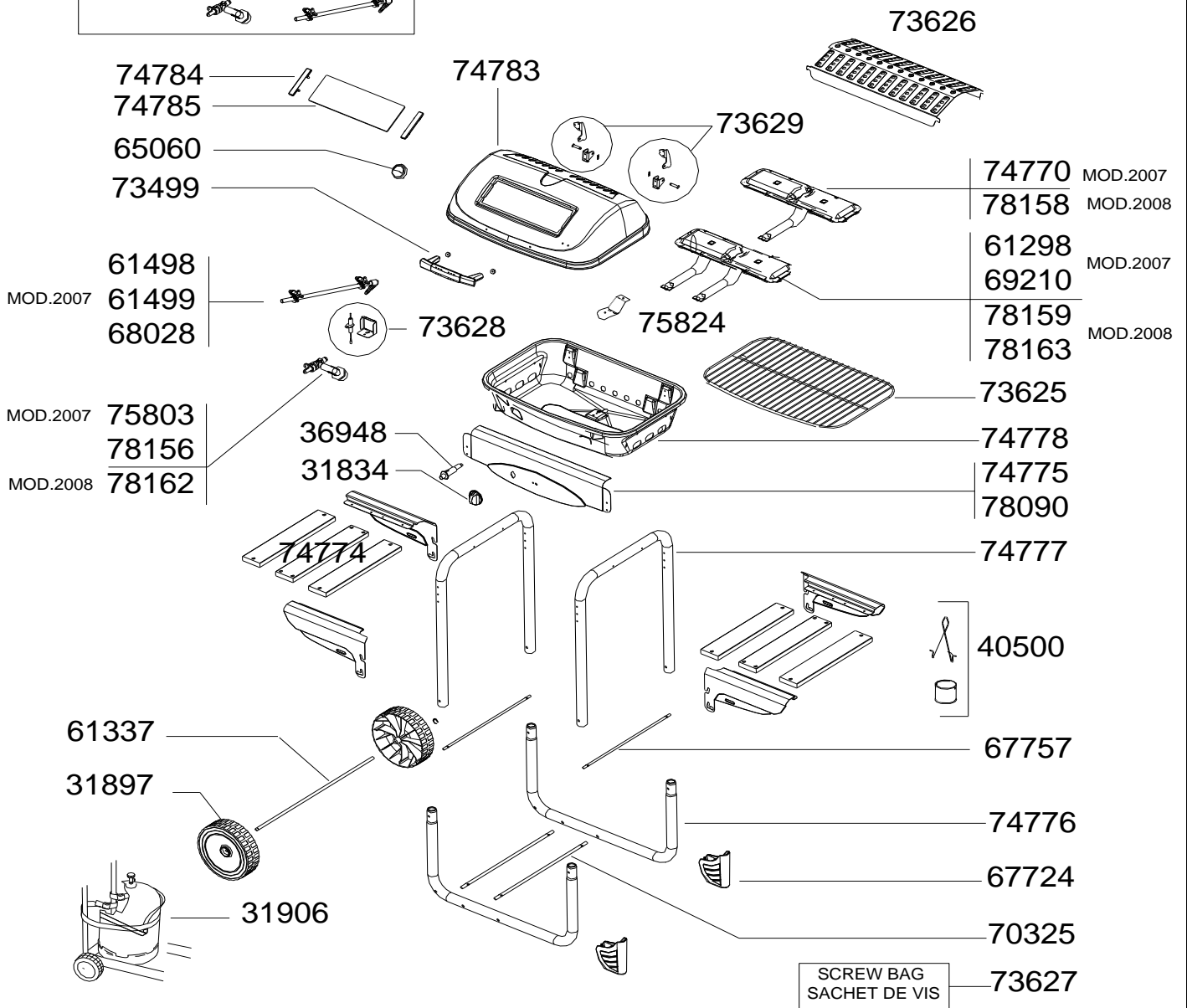

BARBECUES PRIMERO - PRIMERO CLASSIC & CLASSIC DUO



REF.	POINTS	GB - DESIGNATIONS	DESIGNATIONS - F -	PRIMERO	PRIMERO CLASSIC	PRIMERO CLASSIC DUO
31834	30	FRONT PANEL KNOB (X2)	VOLANT DE CONSOLE (X2)	X	X	X
31897	50	WHEEL DIAMETER 175 (X 1)	ROUE DIAMETRE 175 (X 1)	X	X	X
31906	30	CYLINDER STRAP	SANGLE BOUTEILLE	X	X	X
36948	60	SIMPLE IGNITER	PIEZO SIMPLE	X	X	X
40500	40	GREASE CAN + WIRE	BOITE A GRAISSE + FIL	X	X	X
61298	165	BURNER 28 Mb	BRULEUR 28 Mb			X
61337	30	AXLE WHEEL	AXE DE ROUE	X	X	X
61498	150	GAS PIPE 28 MB- 1/2"	TUBULURE COMPLETE 28MB -1/2"			X
61499	150	GAS PIPE 50 MB- 1/4"	TUBULURE COMPLETE 50MB-1/4"			X
63558	30	JET	INJECTEUR			X
65060	50	THERMOMETER	THERMOMETRE		X	X
66340	30	JET	INJECTEUR			X
67724	30	FOOT	PIED	X	X	X
67757	30	CYLINDER STOP WIRE	FIL ARRET BOUTEILLE	X	X	X
68028	150	GAS PIPE 28 MBAR - EXPORT NOZZLE	TUBULURE 28 MBAR - ABOUT EXPORT			X
69210	150	BURNER 50 MBAR	BRULEUR 50 MBAR			X
70325	70	CYLINDER WIRE (x 3)	FILS SUPPORT BOUTEILLE (x 3)	X	X	X
73499	60	HANDLE	POIGNEE	X	X	X
73625	90	COOKING GRID	GRILLE DE CUISSON	X	X	X
73626	70	BURNER TENT	TENTE PROTEGE BRULEUR	X	X	X
73627	90	SCREW BAG	SACHET DE VIS	X	X	X
73628	50	ELECTRODE + HOLDER	ELECTRODE + CACHE ELECTRODE	X	X	X
73629	60	LID HINGES	ENSEMBLE CHARNIERES COUVERCLE	X	X	X
74770	80	BURNER 28 MBAR	BRULEUR 28 MBAR	X	X	
74774	70	SET OF 3 PLANKS	JEU DE 3 LATTES	X	X	X
74775	80	FRONT PANEL	CONSOLE	X	X	
74776	90	LOWER TUBE	TUBE INFERIEUR	X	X	X
74777	90	UPPER U TUBE	TUBE U SUPERIEUR	X	X	X
74778	190	BASE	CUVE	X	X	X
74783	220	LID	COUVERCLE		X	X
74784	40	GLASS HOLDER (x 2)	SUPPORT VITRE (x 2)		X	X
74785	70	GLASS (+ HOLDER X 2)	VITRE (+SUPPORT X 2)		X	X
75802	30	JET	INJECTEUR	X	X	
75803	100	TAP 28 MBAR 1/4"-CH (MOD.2007)	ROBINET 28 MBAR 1/4"-CH (MOD.2007)	X	X	
75824	30	BURNER BRACKET	PONTET BRULEUR	X	X	
78090	100	CONTROL PANEL	CONSOLE			X
78156	100	TAP 28 MB - ABOUT EXPORT (MOD 2008)	ROBINET 28 MB - ABOUT EXPORT (MOD 2008)	X	X	
78158	150	BURNER 28 MBAR & 50 MBAR (MOD 2008)	BRULEUR 28 MBAR & 50 MBAR (MOD 2008)	X	X	
78159	150	BURNER 50 MB (MOD 2008)	BRULEUR 50 MB (MOD 2008)			X
78162	110	TAP 28 MB 1/4" - CH (MOD.2008)	ROBINET 28 MB 1/4" - CH (MOD.2008)	X	X	
78163	150	BURNER 28 MBAR (MOD 2008)	BRULEUR 28 MBAR (MOD 2008)			X